

SIERRA VISTA SPECIFIC PLAN  
GENERAL PLAN AMENDMENT FOR WB-52  
AUGUST 15, 2023

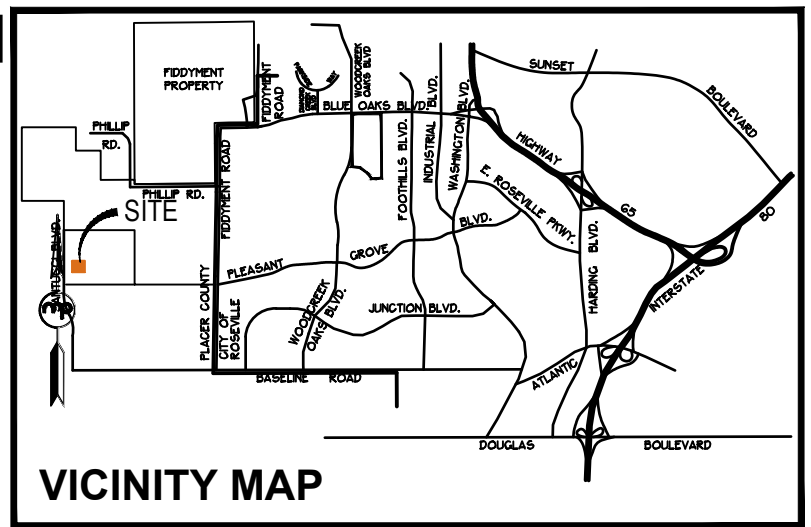

EXISTING GENERAL PLAN

PROPOSED GENERAL PLAN

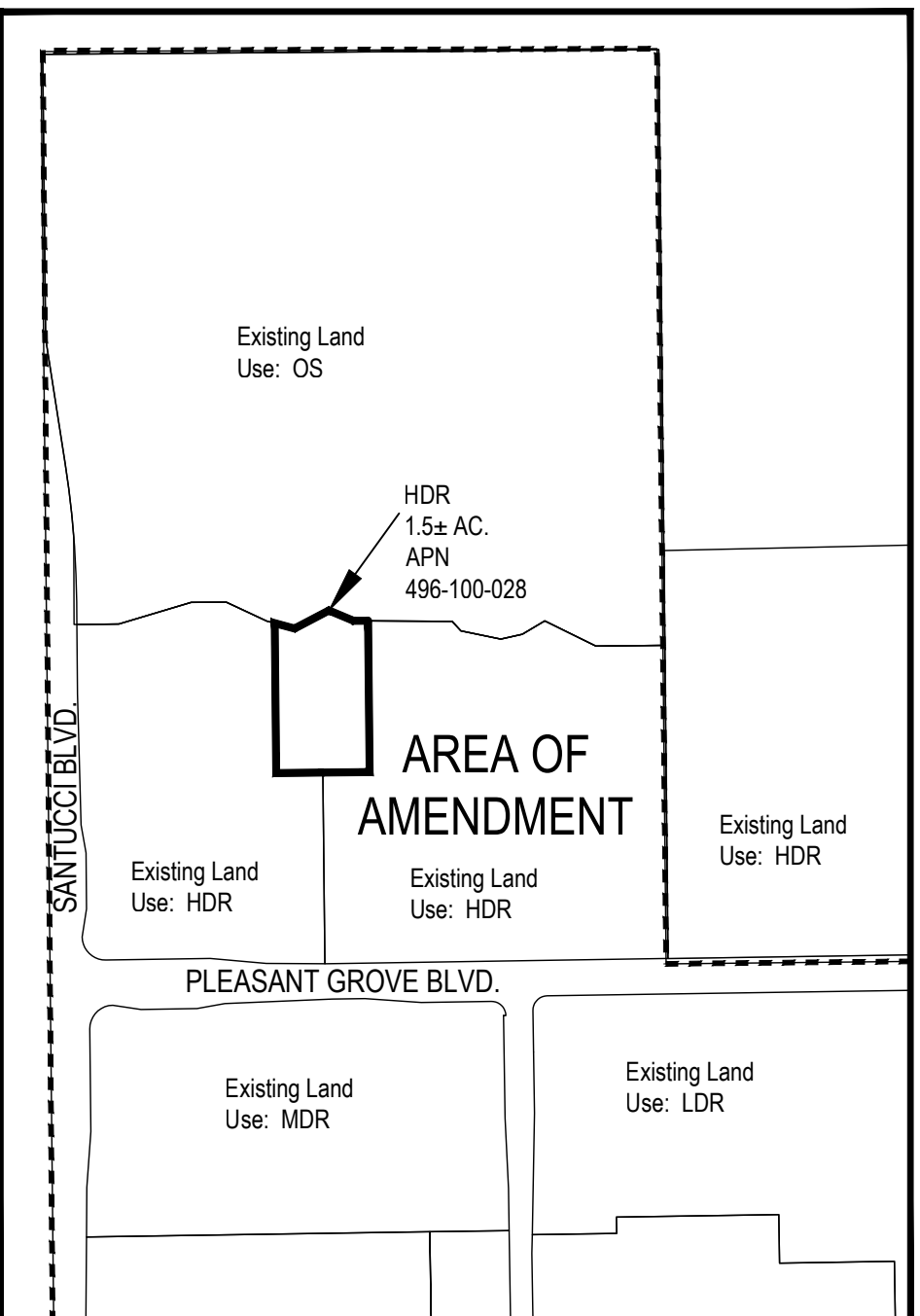
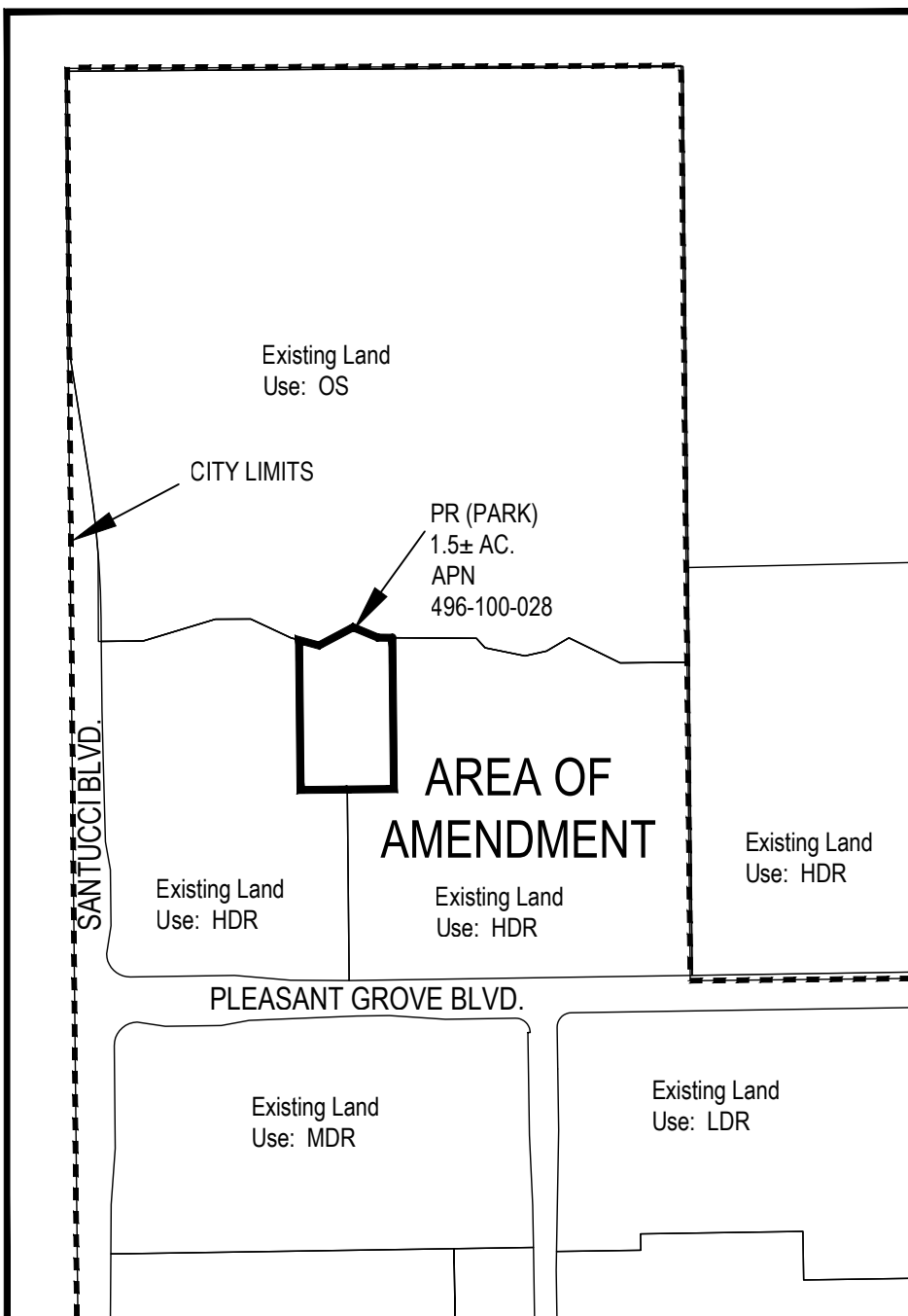

ASSESSOR'S PARCEL NUMBER: 496-100-028

EXISTING LAND USE: PR - PARK

PROPOSED LAND USE: HDR - HIGH-DENSITY RESIDENTIAL

SITE AREA: 1.5 ± ACRES

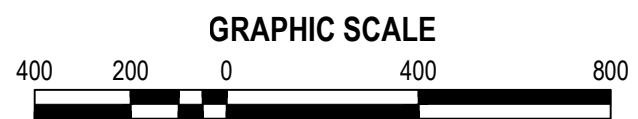

@ 17" X 11" SHEET SIZE



**MORTON & PITALO, INC.**  
CIVIL ENGINEERING • LAND PLANNING • LAND SURVEYING  
LANDSCAPE ARCHITECTURE • TRAFFIC ENGINEERING  
400 Coolidge Drive, Suite 140 • Folsom, CA 95630  
phone: 916.984.7621 • fax: 916.984.9617 • survey fax: 916.563.6770  
survey email: staking@mpengr.com • web: www.mpengr.com